

Lifting points

for welding

SPECIFICATION

Steel, German Material No. 1.6541

- forged
- high-tensile tempered
- 100 % electro magnetic tensile tested to EN 1677
- phosphated

INFORMATION

Lifting points GN 589 are distinguished for their very low dimensions. They provide high dynamic and static strength and can be load from any direction with approved safety (safety factor 4) for all loading directions.

The rated load carrying capacity listed in the above table is clearly marked on the lifting point. It applies to the most unfavourable load application of the load types listed opposite

Lifting points GN 589 comply with Mechanical Engineering Directive 2006 / 42 / EG.

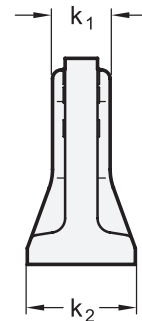
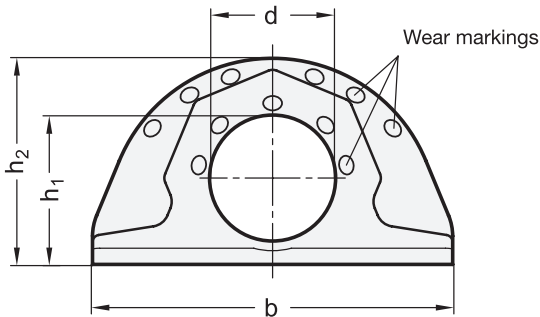

GN 589

Description	b	d	h1	h2	k1	k2	Nominal load (WLL)	max. permitted lashing force in daN (LC)	⚖
GN 589-100	100	35	41.5	57	16	30	1.6	3200	435
GN 589-137	137	50	59	80	23	41	3.2	6400	1100
GN 589-172	172	60	71.5	99	27	51	5	10000	2160
GN 589-228	228	80	95	130	38	70	10	20000	5260





Method of mounting										
Number	1	1	2	2	2	2	2	3 and 4	3 and 4	3 and 4
Angles of inclination	0°	90°	0°	90°	0° to 45°	45° to 60°	asymm.	0° to 45°	45° to 60°	asymm.
Factor	1	1	2	2	1.4	1	1	2.1	1.5	1
b = 100	1.6 t	1.6 t	3.2 t	3.2 t	2.2 t	1.6 t	1.6 t	3.4 t	2.4 t	1.6 t
b = 137	3.2 t	3.2 t	6.4 t	6.4 t	4.5 t	3.2 t	3.2 t	6.8 t	4.8 t	3.2 t
b = 172	5.0 t	5.0 t	10.0 t	10.0 t	7.1 t	5.0 t	5.0 t	10.6 t	7.5 t	5.0 t
b = 228	10.0 t	10.0 t	20.0 t	20.0 t	14.1 t	10.0 t	10.0 t	21.2 t	15.0 t	10.0 t

SAFETY INSTRUCTIONS

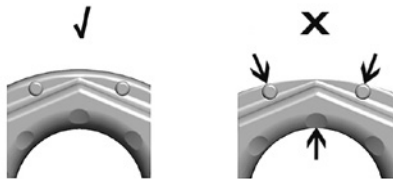

Use permitted
No traces of wear

Use not permitted
Criteria reached:
Material worn down to the wear marks

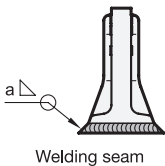

The above details refer to the maximum load in metric tonnes.

Carefully check the wear markings for the abrasion of the lifting point.

Lifting point	Size fillet seam	Length	Volume in cm ³
b = 100 (1.6 t)	a = 4	251	4.016
b = 137 (3.2 t)	a = 6	344	12.38
b = 172 (5.0 t)	a = 7	431	21.10
b = 228 (10.0 t)	a = 8	576	36.86

Welding must be made by an approved welder in accordance with EN 287-1. The specified loading values are valid for an operating temperature of between -40 °C and +200 °C. Load capacities under higher temperatures provided on request. Operating instructions with more details and specifications are included with every delivery (see also www.elsa-ganter.com)